



RESIDENTIAL ELECTRIC WATER HEATERS  
**STANDARD, CASCADE  
& SUPER CASCADE**

30 | 40 | 60 | IMP. GALLONS



Proudly  
Canadian

**Giant**<sup>®</sup>  
Enhancing everyday living

# BENEFITS

## 1 - FACTORY INSTALLED TEMPERATURE & PRESSURE-RELIEF VALVE

Protects the tank from the damaging effects of excessive temperature and pressure.

## 2 - FACTORY INSTALLED 3/4" NPT DI-ELECTRIC NIPPLES

Extend the life of the water heater by providing excellent corrosion protection.

## 3 - FACTORY INSTALLED HEAT TRAPS

Helps reduce the migration of hot water, thus limiting heat loss escaping through inlet and outlet fittings.

## 4 - AUTOMATIC TEMPERATURE CONTROL

Adjustable thermostats will provide years of reliable trouble-free service at the desired water temperature and a safety cut-off is provided for abnormal conditions.

## 5 - INSULATION

A thick uniform blanket of **GREENFOAM** eco-friendly insulation keeps the water hotter for longer periods, reduces stand-by losses and energy costs. **GREENFOAM** contains no HCFC'S (hydrochlorofluorocarbons), CFC'S (chlorofluorocarbons), HFC'S (hydrofluorocarbons) nor VOC's (volatile organic compounds).

## 6 - ELECTRIC ELEMENTS

All models are equipped with CSA approved bolt-on immersion elements made by Giant. These elements can be easily replaced with no special tools, resulting in low maintenance costs.

## 7 - GLASS-LINED INNER TANK

A uniquely formulated blue cobalt glass enriched with zircon is fused to specially treated steel at 1,600°F (871°C) to provide the best coating available against corrosion for many years. The tank is certified at a test pressure of 300 PSI (2,068 kPa) and a working pressure of 150 PSI (1,035 kPa).

## 8 - HIGH QUALITY MAGNESIUM ANODE

Provides excellent protection against the corrosive effects of water and extends tank life.

## 9 - DRAIN VALVE

Tamper-resistant, one-piece drain valve is installed for easy drainage.

## 10 - OVERFLOW SYSTEM

A 90° elbow overflow tube is supplied with each residential electric water heater.

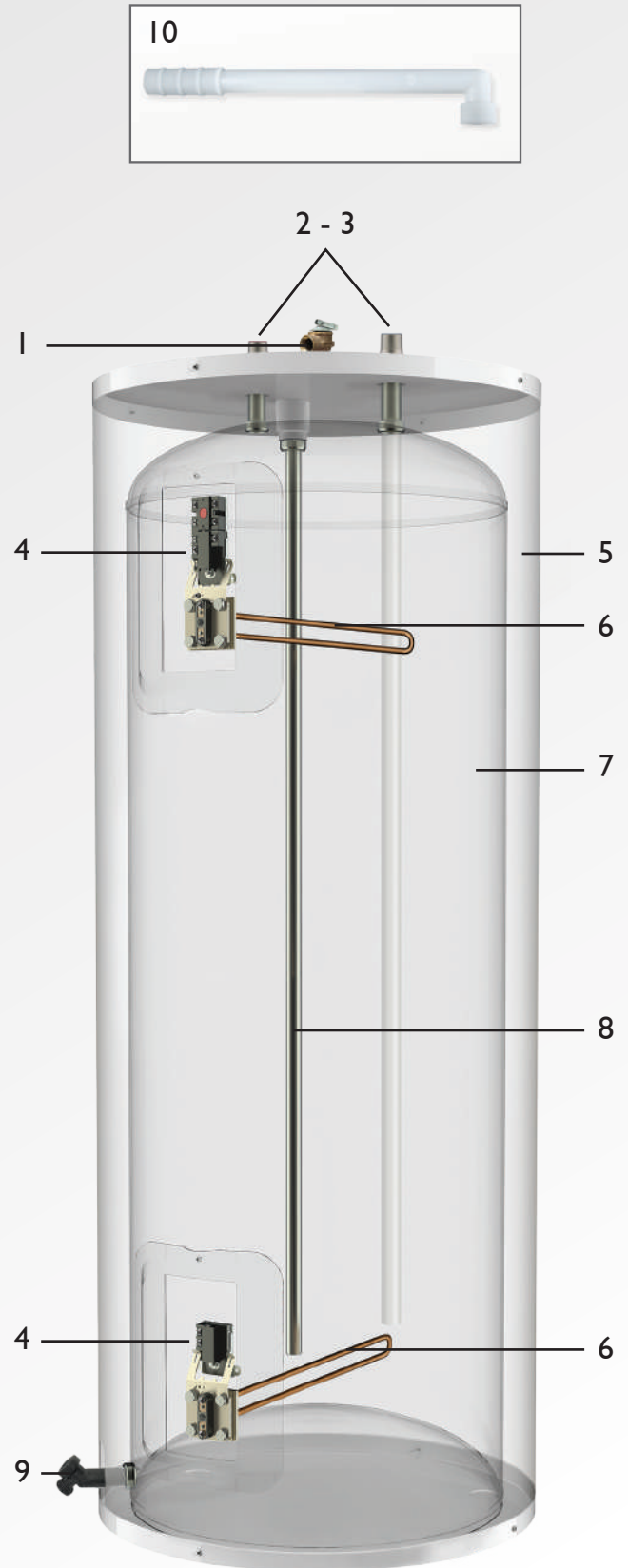

**Standard**

# STANDARD MODELS

**WARRANTY**  
**6** years | **1** year  
against inner tank leakage | on component parts

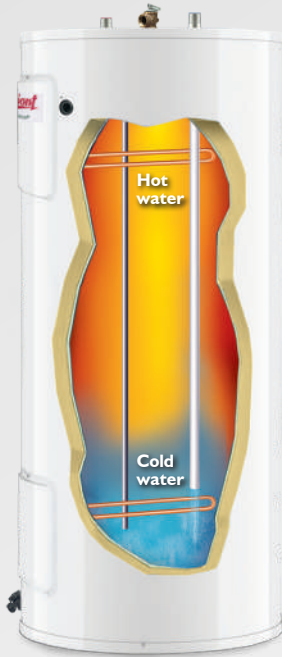

Inside View



60 gallons

30 gallons

40 gallons

	<b>Standard</b>	<b>Cascade</b>	<b>Super Cascade</b>
eco-friendly insulation	✓	✓	✓
Di-electric nipples	✓	✓	✓
Magnesium anode	Normal	Normal	Oversized
Low watt density elements	—	✓	✓
Rustproof glass-lined inner coating – blue cobalt glass enriched with zircon	Single coating	Single coating	Double coating
Tamper-resistant drain valve	Plastic	Plastic	Brass
Automatic temperature control	✓	✓	✓
Safety valve – Factory installed	✓	✓	✓
90° horizontal overflow elbow tube	✓	✓	✓
Vertical evacuation tube	—	—	✓
Bottom cold water entry	—	✓	✓
10% more hot water	—	✓	✓
<b>Warranty against inner tank leakage</b>	<b>6 years</b>	<b>8 years</b>	<b>10 years</b>
<b>Warranty on component parts</b>	<b>1 year</b>	<b>5 years</b>	<b>5 years</b>



# CASCADE & SUPER CASCADE MODELS

## COLD WATER INTAKE

### TOP ENTRY

Cold water eddies down and cools the hot water at the bottom of the tank.



**Standard**

### BOTTOM ENTRY

Cold water stays at the bottom of the tank until it heats up.

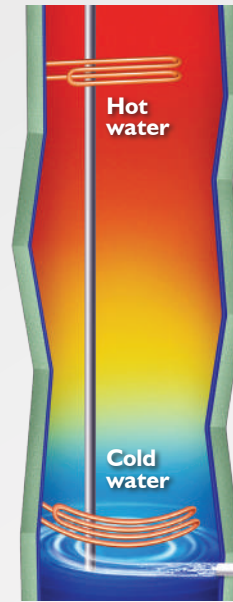

# CASCADE & SUPER CASCADE MODELS



## BENEFITS

Cascade models offer most features of the Standard model plus:

- **Low watt density elements**  
For longer element life.
- **Bottom entry**  
Bottom water entry allowing to have 10% more hot water.
- **Warranty against inner tank leakage**  
Limited warranty of EIGHT (8) years against inner tank leakage from the date of installation.
- **Warranty on component parts**  
Limited warranty of FIVE (5) years on heating elements. Limited warranty of ONE (1) year on thermostats.



## BENEFITS

Super Cascade models offer most features of the Standard and Cascade models plus:

- **Oversized magnesium anode**  
High quality.
- **Double coating of blue cobalt glass**  
Protects the inner tank against corrosion and perforation.
- **Brass safety drain valve**  
For easy drainage.
- **Vertical evacuation tube**  
Provided to facilitate the redirection of water to the retention tank.
- **Warranty against inner tank leakage**  
Limited warranty of TEN (10) years against inner tank leakage from the date of installation.
- **Warranty on component parts**  
Limited warranty of FIVE (5) years on heating elements. Limited warranty of ONE (1) year on thermostats.



# Standard

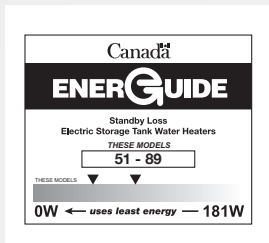
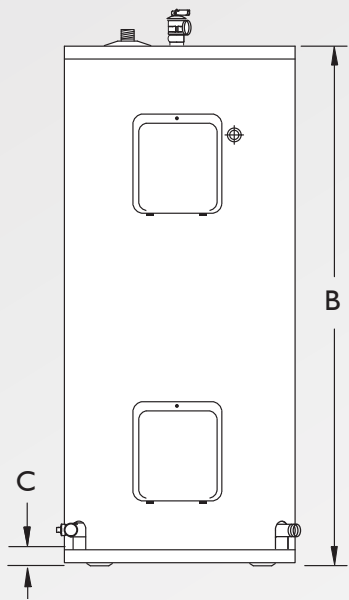
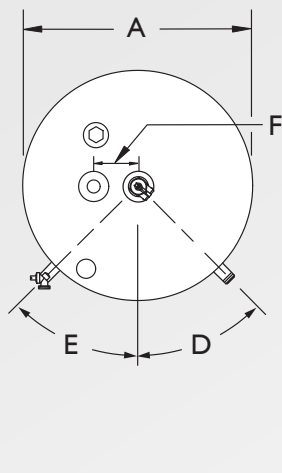
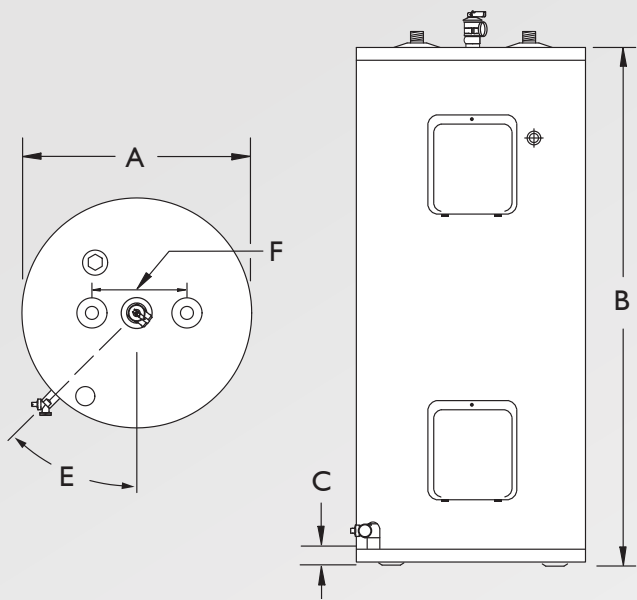

## SPECIFICATIONS & DIMENSIONS

Models	Storage Capacity			Factory installed wattages				Standby loss	Diameter (A)		Height (B)		C	D	E	F	Estimated ship. weight	
	U.S. (gal.)	Litre	Imp. (gal.)	120 V Watts	120 V Amp.	208 V Watts	208 V Amp.		240 V Watts	240 V Amp.	inches	(cm)					inches	(cm)
<b>STANDARD</b>																		
142STE	36	135	30	1,500	12.5	3,000	14.4	3,000	12.5	51	22 (56)	36 1/4 (92)	2 1/2 (6)	—	45°	8 (20)	115 (52)	
152STE	49	184	41	1,500	12.5	3,000	14.4	3,000	12.5	62	22 (56)	49 1/4 (125)	2 1/2 (6)	—	45°	8 (20)	140 (64)	
172STE	74	279	61	1,500	12.5	4,500	21.6	4,500	18.8	78	24 (61)	59 7/8 (152)	2 1/2 (6)	—	45°	8 (20)	185 (84)	
<b>CASCADE &amp; SUPER CASCADE</b>																		
152B,E*	49	184	41	1,500	12.5	3,000	14.4	3,000	12.5	66	22 (56)	49 1/4 (125)	2 1/2 (6)	45°	45°	4 (10)	140 (64)	
172B,E*	74	279	61	1,500	12.5	4,500	21.6	4,500	18.8	89	24 (61)	59 7/8 (152)	2 1/2 (6)	45°	45°	4 (10)	185 (84)	

Toxic chemicals, such as those used for boiler treatment, must NEVER be introduced into this system.

These units must NEVER be connected to any existing heating system or component(s) previously used with a non-potable water heating appliance.

\*British-Colombia requirements may differ, please contact your local provider.

### STANDARD

### CASCADE

### SUPER CASCADE

**WARRANTY**  
**6 years** | **1 year**  
against inner tank leakage | on component parts

**WARRANTY**  
**8 years** | **5 years**  
against inner tank leakage | on component parts

**WARRANTY**  
**10 years** | **5 years**  
against inner tank leakage | on component parts

Giant offers a SIX (6) year limited warranty on residential electric **STANDARD** water heaters against inner tank leakage from the date of installation. ONE (1) year limited warranty on component parts.

Giant offers an EIGHT (8) year limited warranty on residential electric **CASCADE** water heaters against inner tank leakage from the date of installation. FIVE (5) year limited warranty on component parts.

Giant offers a TEN (10) year limited warranty on residential electric **SUPER CASCADE** water heaters against inner tank leakage from the date of installation. FIVE (5) year limited warranty on component parts.

For more specific warranty details including exceptions, consult the owner's manual that comes with each water heater.



**A family company since 1945.**

40 Lesage Avenue, Montréal-East, Québec, H1B 5H3 CANADA  
 Telephone: 514-645-8893 • Toll free: 1-800-363-9354  
 General fax: 514-640-0969  
 Customer Service fax: 514-645-8413

In accordance with our company policy of on-going product improvement, Giant Factories Inc. reserves the right to make changes without prior notice.

[www.giantinc.com](http://www.giantinc.com)